

Type 600/1000 Stainless Steel Ball Valves

Reduced port, Uni-body design, Threaded ends

Page 8 for Pressure-Temperature Ratings

Features

- Blowout-proof stem
- Choice of threaded ends:
 - Rc threads to BS 21 (Fig. UTKM)
 - NPT threads to ASME B1.20.1 (Fig. AKUTKM)

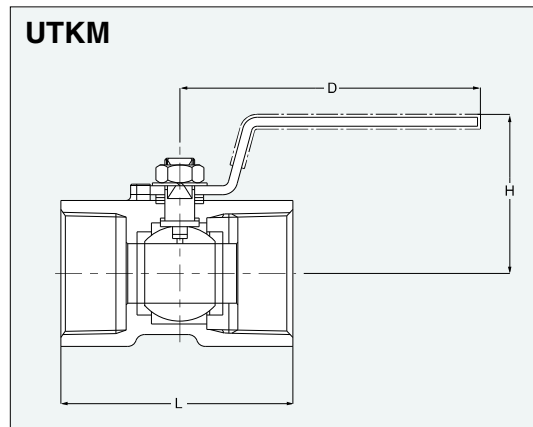

Standard materials

Parts	Materials
Body	CF8M
Ball	316
Stem	316
Seat	Glass filled PTFE or HYPATITE® PTFE *
Gland packing	Reinforced PTFE
Handle	Plastic covered S.S.

* HYPATITE® PTFE for Type 1000

End-to-end dimensions: KITZ standard

Dimensions

Unit: mm

Valve Size	in.	1/4	3/8	1/2	3/4	1	1 1/4	1 1/2	2
	mm	8	10	15	20	25	32	40	50
Ball Bore		4.5	6.8	9.2	12.5	16	20	24.5	32
L		39	44	56.5	59	71	78	83	100
H		31	36	41	44	48	54	65	75
D		60	70	85	85	100	100	125	125

Valve operator

Lever operation
T-type handle as option

Test pressure

Shell (Hydrostatic):
 Type 600: 6.20MPa (900psi)
 Type 1000: 10.34MPa (1500psi)
 Seat (Air): 0.55MPa (80psi)