

TD-10NA,30NA

ULTRA STEAM TRAP
TRAP STAR™

Bucket	Float	Disc	Bellows
Bimetal	Wafer	By-pass	Stainless steel
Connector	Side to side	Down to Up	Up to Down

■Features

1. Bimetal solves air-binding problem and ensures a smooth discharge of cold condensate or air at the start of operation, enabling steam equipment to efficiently start to run.
2. The stainless steel valve disc and valve seat, which are subjected to special heat treatment, offers excellent durability.
3. The valve disc, valve seat and bimetal can be replaced on site without removing the steam trap from the piping.
4. Easy maintenance and inspection due to simple structure: the valve disc is only movable part.
5. Compact, lightweight and inexpensive. Applicable in wide working pressure range and adjustment-free.
6. Installable in any direction and easy to plumb.
7. Free of improper operation and steam leakage due to air insulation type.
8. Built-in strainer eliminates requirement for strainer before the product.



TD-10NA

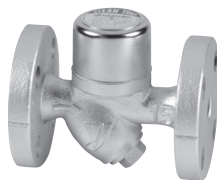

TD-30NA

■Specifications

Model	TD-10NA	TD-30NA	
Nominal size		15-25A	
Application	Steam condensate		
Working pressure	0.035-2.0 MPa	0.035-1.0 MPa	0.035-2.0 MPa
Allowable back pressure	50% or less of inlet pressure		
Max. temperature	220°C		
Connection	JIS Rc screwed	JIS 10K FF flanged	JIS 20K FF flanged
Material	Body	Ductile cast iron	
	Disc, seat	Stainless steel (special heat treatment)	

■ Dimensions (mm) and Weights (kg)

· TD-10NA

Nominal size	d	L	H ₁	H ₂	Weight
15A	Rc 1/2	90	49	55.5	0.9
20A	Rc 3/4	90	53	60.5	1.2
25A	Rc 1	90	56	62.5	1.4

· TD-30NA

Nominal size	L	H ₁	H ₂	Weight
15A	125	51	59	2.3
20A	140	54	63	3.4
25A	150	63	63	4.1

· The dimensions of the product with JIS 10K FF flanged and the product with JIS 20K FF flanged are identical.

· The thickness of JIS 10K FF flanges conforms to that of JIS 20K FF flanges.

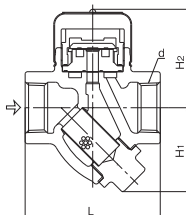

TD-10NA

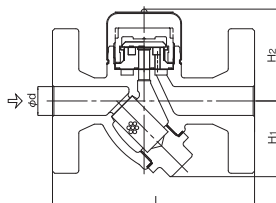

TD-30NA

■ Maximum Continuous Discharge Capacity Chart

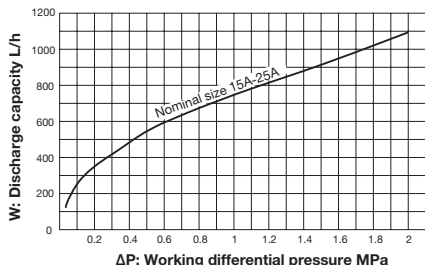

■ Installation Posture

* The steam trap can be installed horizontally, slidingly, or vertically.

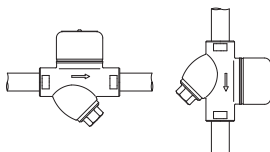

*The discharge capacity shown on the above chart is the maximum value. In designing a system, select a steam trap with a sufficient safety factor (four to five times the regular level). For example, if a discharge capacity of 100 kg/h is required, select a steam trap capable of discharging 400 to 500 kg/h.