

TYPE 600

BRASS BALL VALVE, FULL PORT

Bolted body and cap, Blowout-proof Stem, Double O-ring stem seals, Threaded ends to BS21

W.O.G. non-shock 4.14 MPa (600 psi), W.O.G. 150°C 1.03 MPa (150 psi)

*Size 4 : W.O.G. non-shock 2.76MPa (400psi), W.O.G. 150°C 0.69MPa (100psi)

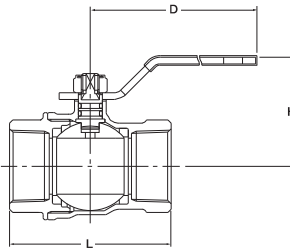

Materials

Parts	Material
Body	Brass/Bronze*
Body cap	Brass/Bronze*
Stem	Brass: Nickel plated
Ball	Brass: chrome free plated (Size 1/4 to 3) Brass: Nickel-chrome plated (Size 4)
Ball seat	PTFE
O-ring	FKM

*Size 4 only

Fig. SZA

• Threaded end to BS21

Dimensions

Nominal Size	inch	1/4	3/8	1/2	3/4	1	1 1/4	1 1/2	2	2 1/2	3	4	mm
	mm	8	10	15	20	25	32	40	50	65	80	100	
L		42	42	53	60	72	84	92	110	138	167	193	
H		37	37	40	43	50	55	65	72	101	113	131	
D		70	70	80	80	110	110	150	150	200	300	300	